



# TERMINAL

The **TERMINAL** range comprises a large assortment of perimeter joint or edging profiles in aluminium covered in wooden finishes are available, plus anodized finishes. They are used in various laying situations. Ideal as an edging profile for wood parquet, laminate and melamine-coated floors. They finish the floor where it joins to abutting surfaces, windows, glazed areas, doors, terraces and may also be used for joining two floors: wood/tiles, wood/carpeting.

ALUMINIUM COVERED WOODEN FINISHES AND ANODIZED FINISHES



**ANODIZED ALUMINIUM** (6 anod. alum. finishes of which 3 on demand) thermo packed - bar length 2,7 lm - pack. 40 Pcs - 108 lm (H 11 - H 13 - H 15 mm - 80 lm)

Article	H mm		
PINT... 07	7		
PINT... 09	9		
PINT... 11	11		
PINT... 13	13		
PINT... 15	15		

**ALUMINIUM COVERED** (80 wooden finishes of which 70 on demand) thermo packed - bar length 2,7 lm - pack. 20 Pcs - 54 lm (H 11 - H 15 mm - 80 lm)

Article	H mm		
PINT... 09	9		
PINT... 11	11		
PINT... 15	15		

Available in the finishes: AO - AA - AB (AT, CH and SB available on demand with a minimum quantity order of 100 pcs) and in the wooden finishes: 05W-08W-10W-29W-30W-31W-34W-37W-41W-42W.

The code of the selected colour must be added to the article code. E.g.: PINT... 07 (chosen finish anod. gold) PINTAO 07.

**ANODIZED ALUM.** (6 anod. alum. finishes of which 3 on demand) thermo packed bar length 0,90 lm - 20 Pcs - BLISTER PACKS



Article	H mm		
PINT... 07S	7 / 8		
PINT... 09S	9 / 10		
PINT... 11S	11 / 12		
PINT... 15S	15 / 16		

**ALUMINIUM COVERED** (80 wooden finishes of which 70 on demand) thermo packed bar length 0,90 lm - 20 Pcs - BLISTER PACKS



Article	H mm		
PINT... 09S	9 / 10		
PINT... 11S	11 / 12		
PINT... 15S	15 / 16		

Available in the finishes: AO - AA - AB (AT, CH and SB available on demand with a minimum quantity order of 100 pcs) and in the wooden finishes: 05W-08W-10W-29W-30W-31W-34W-37W-41W-42W.

The code of the selected colour must be added to the article code. E.g.: PINT... 07S (chosen finish anod. gold) PINTAO 07S.

## ANODIZED COLOURS



## \* ANODIZED COLOURS ON DEMAND

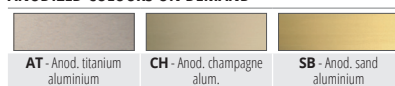

## WOODEN COLOURS

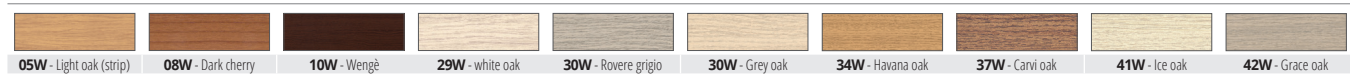

## \* WOODEN COLOURS ON DEMAND



On request it is possible to realize other finishes of the color range: minimum order 100 pcs. Production delay 4/5 weeks. Price to be agreed. For sample finishes, contact the sales office for minimum quantities, timing and costs.

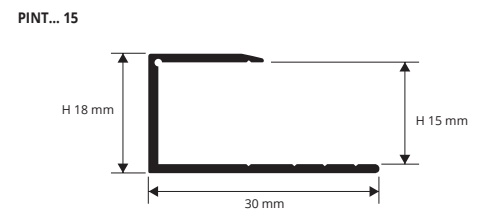
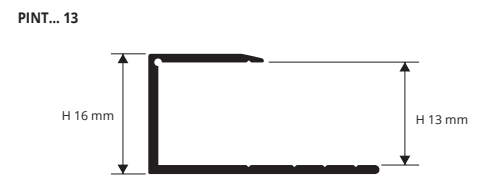
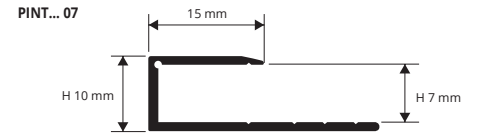

terminal - outer profiles

## EXAMPLES AND INSTRUCTIONS FOR LAYING METHODS

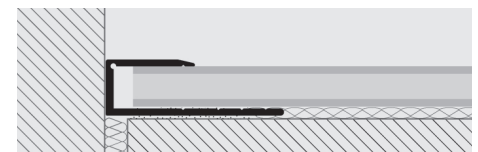

1. Choose the TERMINAL according to the required height and finish and fix with screws and screw anchors or with glue/silicone; the profile must be placed next to the abutting surface e.g. wall, glazing, etc. 2. Align the laminate/melamine/wood floor, ensuring that a large enough gap is left to accommodate the natural expansion between the floor and the profile (approx. 3/10mm on one side).