

**GDA 55** is a structural joint for floors, 35, 50 and 80 mm, in good quality natural aluminium with the interchangeable neoprene insert allowing the joint to expand and contract. Visible thickness 55 mm (**GDA 55**), bar length 3 lm. Black or Grey insert. Bear weights of cars, with the wheel loads up to 650 kg and trucks with a maximum load of 1000 kg on the wheel.

# GDA 55

ALUMINIUM  
+ NEOPRENE INSERT

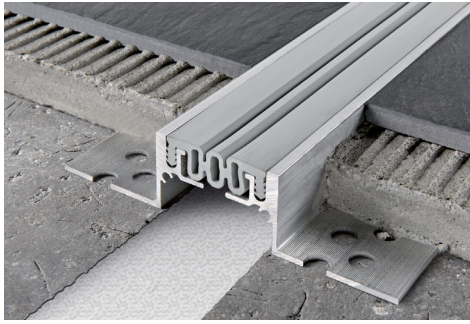

**ALUMINIUM + BLACK / GREY NEOPRENE INSERT**  
bar length 3 lm

Article	L x H x L1 mm
GDA 5535...	55 x 35 x 155
GDA 5550...	55 x 50 x 155
GDA 5580...	55 x 80 x 155

Movement mm: +/- 10

Available in the colours: N - G.

The code of the selected finish must be added to the article code.  
E.g.: GDA 5535....(chosen insert colour black) GDA 5535N

**Insert in smooth neoprene on demand.**

**ANGLES BAR ALUMINIUM + BLACK NEOPRENE INSERT**  
bar length 3 lm

Article	L x H x L1 mm
GDAP 5535	55 x 35 x 105
GDAP 5550	55 x 50 x 105
GDAP 5580	55 x 80 x 105

**Insert in smooth neoprene on demand.**

**COLOURS**

N - Black (RAL 9005)	G - Grey (7038)
----------------------	-----------------

**EXAMPLES AND INSTRUCTIONS FOR LAYING METHODS**

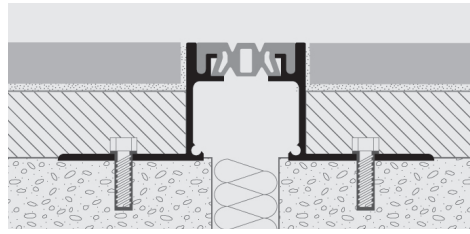

1. Choose the expansion joint with suitable height for the thickness of the floor and the screed/floor rough and choose the colour of the insert. 2. Fix the punched flanges to the substrate using screws and screw anchors, calculating the fixing points at 30 cm intervals on both sides. 3. Make the screed over the punched flanges of the structural or expansion joint, calculating the thickness of the final floor, and then lay the floor as normal.

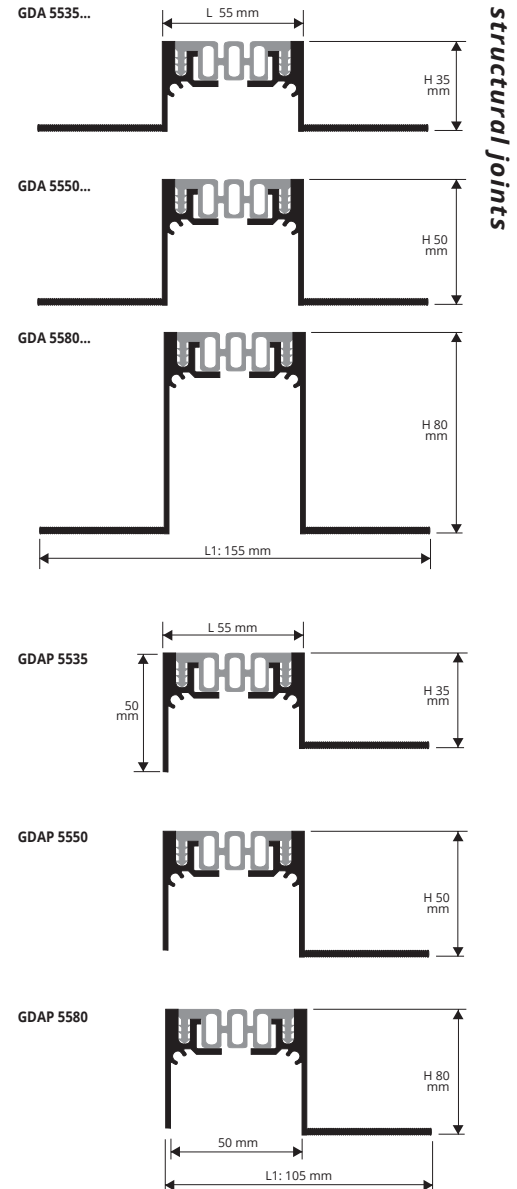

# FIREPROOF CORD

MINERAL WOOL AND FIBREGLASS

**FIREPROOF GLUE FOR CORD FIXING**

Article	Pack. Kg
CIC 014	1,4 *
CIC 7	7 *

The delivery of the test certificate depends on the use of silicate glue for the fixing of the same.  
The cord is certified in accordance with the new European Standard EN 13501-2.  
Consumption of sealant is of about 50 g per linear metre of cord.

**FIREPROOF CORD - Diameter 20 - 60 mm**

Article	Ø mm	lm Roll
CDT 20	20	30
CDT 30	30	30
CDT 40	40	30
CDT 50	50	25
CDT 60	60	25



\* = Production on demand with minimum quantity of 100 pcs. Production delay 4/5 weeks. Price to be agreed